



# Product Specification Sheet Aureol BeamShaper



The Aureol BeamShaper is a high performance projection spotlight able to precisely shape and control a beam of light using the four integral shutters or project images (stainless steel or glass patterns).

As a part of the Aureol BeamSpot it offers all the same features as the BeamSpot with MR16 12V lamp, integral power supply, accessory and mounting options.

The unique BeamShaper accessory turns any Aureol BeamSpot into a high performance BeamShaper.

## Features

Drop in zoom lens barrel accessory turns any Aureol BeamSpot into a zoom ellipsoidal.

Dedicated designed aspheric lenses to maximize light output and projection clarity.

Beam angle zoom adjustment 26° to 50°.

Integrated pattern mounting.  
E size stainless steel or glass patterns are mounted inside the body.

Four captive shaping shutters.

Rotatable lens barrel allows image rotation with screw lock off.

Lens position (focus) reference scale.

Integrated accessory and two filter mounting slots – to carry color filter 2" round or square (square cut is cheaper) one of which can be up to 2/16" thick or an animation disc drive unit with A size disc 8 5/8" diameter with motor drive options of 1,2, 5, 10 RPM motor. The motor drive mounts into the front slot of the BeamShaper.

Supplied with the GE Precise 50W 25° 12V MR16 lamp.

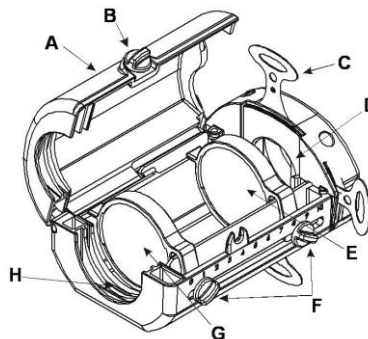

## Configuration

The BeamShaper is mounted into the front accessory slot of the BeamSpot. This allows the "lens tube" to rotate for aligning projected images or the straight edge of the shuttered beam.

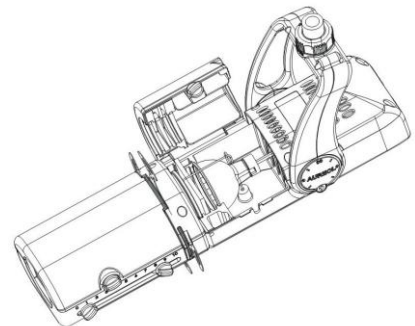

## Key operational features

A: **BeamShaper lid.** This allows access to the lens compartment for inserting patterns or cleaning the lenses.

B: **Lid locking knob.** This locks the BeamShaper lid closed.

C: **Shutters.** Four non-removable shutters are provided to allow you to mask portions of the beam, or to frame around pictures, etc.

D: **Pattern slot.** This slot, just forward of the shutter plates, carries E size glass patterns, which fit directly into the slot, or steel patterns which are inserted in front of the supplied 'pattern spacer' ring.

E: **Rear lens.**

F: **Lens locking knobs.**

G: **Front lens.**

H: **Color filter and accessory slots.**



## Order codes

To order a complete Aureol BeamShaper fixture you must select the order code for the unit of choice from the Aureol BeamSpot datasheet and then order the matching BeamShaper accessory from the list below:

ARLBS01 White BeamShaper head to fit onto BeamSpot - includes 12V / 50W MR16 lamp.

ARLBS02 Gray BeamShaper head to fit onto BeamSpot - includes 12V / 50W MR16 lamp.

ARLBS03 Black BeamShaper head to fit onto BeamSpot - includes 12V / 50W MR16 lamp.



Black White Silver Grey

White - PANTONE® 11-4800  
Blanc de Blanc

## Physical data

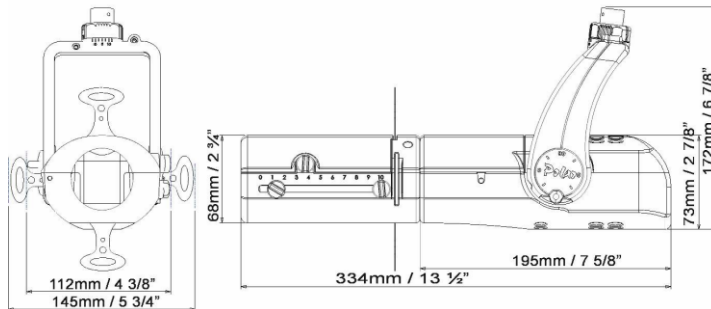

BeamShaper accessory weight only: 1.5lb.

## Photometric data

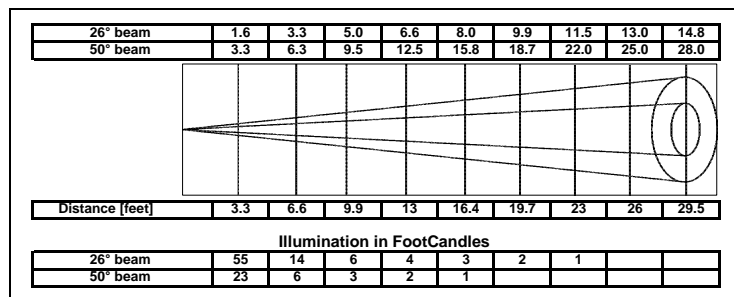

**Note:** The BeamShaper uses Selecon's custom designed aspheric lens to minimize beam distortion and field curvature resulting in excellent pattern projection for a fixture of this type. The actual performance is dictated by the lamp used.

For best results the unit is shipped with the GE Precise 50W 25° 12V MR16 lamp.

Selecon reserves the right to change this product specification without notice (March 2010).